

# Installation Guide

## For HyPanel



# Welcome!

This guide applies to PS51-FANCOIL-EU model of HyPanel.

## Contents

<b>Before We Start</b> .....	<b>2</b>
<b>In the Box</b> .....	<b>3</b>
<b>Check Compatibility</b> .....	<b>4</b>
<b>Wiring</b> .....	<b>7</b>
<b>Installation</b> .....	<b>11</b>
<b>Get Help</b> .....	<b>16</b>

## Before We Start

Your first time installing this product may take up to 40 minutes.  
You' ll get faster after each installation.



### Warning!

The installation procedure involves handling high voltage wiring. Please be careful. To avoid serious personal injury, death, or property damage, turn OFF the power to the circuit and follow all safety precautions before proceeding.

Working with electricity can be dangerous. If you are unsure about, or uncomfortable with the installation, seek the help of a qualified electrician.



### Warning!

Keep the device and all its parts out of the reach of children. The small parts or accessories contained may be a choking hazard to them.

## In The Box

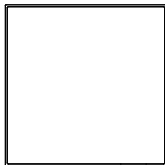

HyPanel X 1

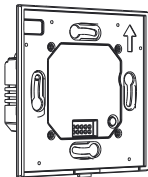

Flush Mounted Module **x1**



NTC Thermistor **x1**

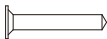

M3x20mm Phillips Self Tapping  
Screw **x2**



M4x20mm Phillips Machine  
Screw **x2**



# Check Compatibility

## Product specifications

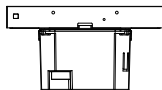

⑤ BOTTOM VIEW

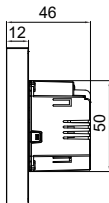

② RIGHT VIEW

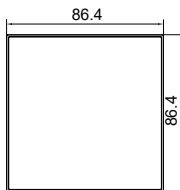

① FRONT VIEW

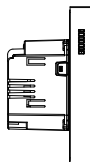

③ LEFT VIEW

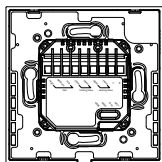

④ BACK VIEW

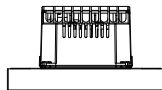

⑥ TOP VIEW

## Working space

Make sure HyPanel is compatible with the location where you want to install it.

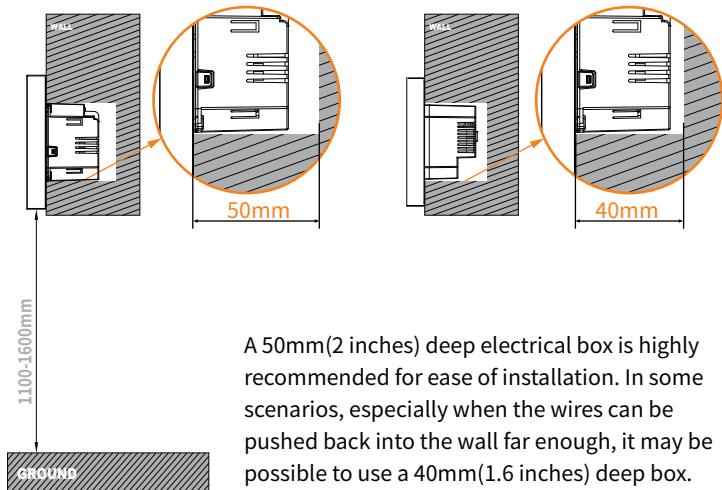

A 50mm(2 inches) deep electrical box is highly recommended for ease of installation. In some scenarios, especially when the wires can be pushed back into the wall far enough, it may be possible to use a 40mm(1.6 inches) deep box.

## Maximum current

- Fan Relay Capacity: 5A (Resistive), 3A (Inductive).
- Valve Relay Capacity: 5A(Resistive), 3A(Inductive).

## 90-260VAC, 50/60 Hz power required

HyPanel can be used in countries with varying standard voltages, from 90V to 260V AC, at a frequency of either 50Hz or 60Hz.

## Neutral wire required for installation

A neutral wire is required for the device to function properly.

## Wire sizes for different connections

- RS485 and NTC: Recommended wire size is  $0.14\text{mm}^2$  -  $0.75\text{mm}^2$  (26-18AWG).
- Fan and Valve: Maximum wire size should be  $1.5\text{mm}^2$  (16AWG).

## Support Wi-Fi connection

HyPanel supports Wi-Fi connectivity on both 2.4GHz and 5GHz frequency bands, complying with the IEEE802.11 b/g/n standards.

# Wiring



## Warning!

Turn OFF the circuit breaker before wiring and proceeding!  
Always use a voltage detector to verify the power is OFF before wiring and installation!

## Wiring Diagram

- The N terminal is intended for connecting the neutral wire.
- The L terminal is for the line wire providing power to the HyPanel.
- High/Med/Low wires regulate the fan motor speed.
- Open/Close wires control cooling or heating valve.
- NTC+ and NTC- terminals are for the thermistor's leads connection. Not required if no thermistor is used.
- 485A and 485B are two signal lines used to connect a third-party device. Not required if no RS485 device is used.

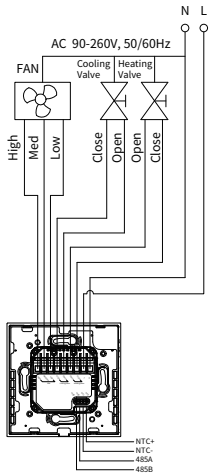

Four Pipe, On/Off

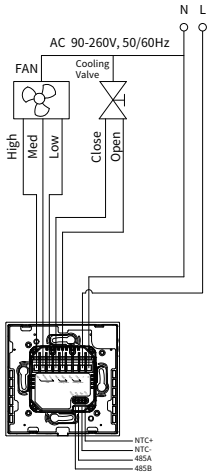

Two Pipe, On/Off

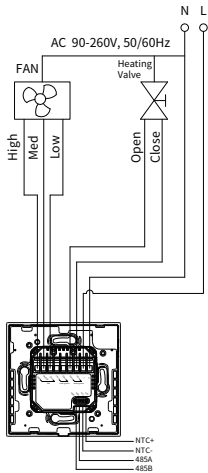

Two Pipe, On/Off

## Connect wires

### 1 Strip and straighten wires

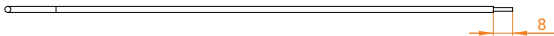

Wires connected to HyPanel should have stripped and straight ends. Remove the plastic sheathing of the wire, and make sure the exposed wire ends measure approximately 8 mm (5/16 inch) in length.

### 2 Connect all wires

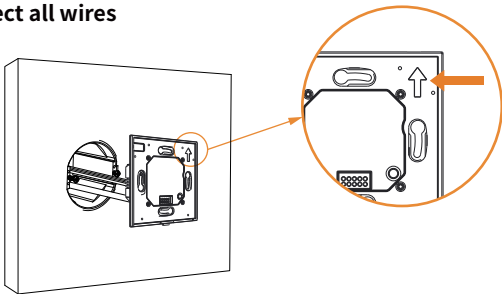

Always make sure the arrow on the front of the flush mounted module is pointing up.

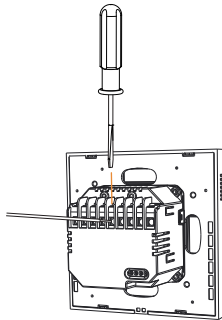
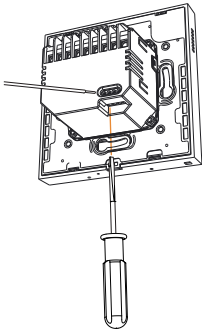

- Plug the wires to the corresponding ports on the back of the flush mounted module.
- Tighten the screws clockwise with a flat-head screwdriver until wires are secure.
- Double check by gently tugging on each wire.
- To use a thermistor, plug the NTC cable into the designated ports at the bottom right.
- To integrate a third-party device with RS485, connect the RS485 cable to the appropriate terminals.

# Installation

## 1 Select screws

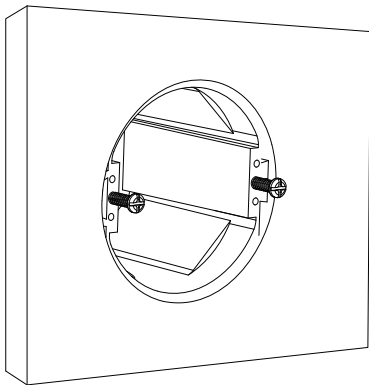

- Select proper screws fitting your electrical box.
- Change the torque on the electric screwdriver to 5kgf.cm.
- Turn screws clockwise with the screwdriver.
- Do not fully tighten the screws. The screw head must protrude at least 3 mm (1/8 inch) from the wall surface.



## 2 Install flush mounted module

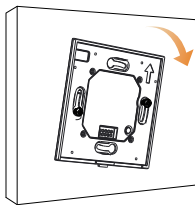

Attach the flush mounted module to the electrical box. The screws should go through the holes on the module.

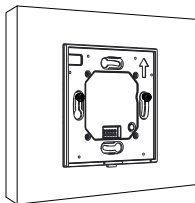

- Adjust the module to be level and ensure it is flush against the wall.
- Tighten the screws to attach the module to the wall, taking care not to over-tighten them.

### 3 Test connected devices

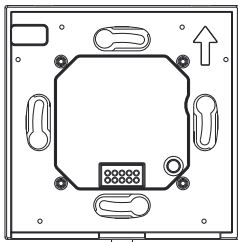

- Turn on the circuit breaker to provide power to the flush mounted module.
- Press the button on the module to check if the connected devices can work.
  - Press the button once, the fan will be turned on and run at its high speed.
  - Press the button once again, turn off the fan.
  - Press the button a third time, the fan will run at its medium speed.
  - Press the button once more to turn off the fan.
- Repeat this process until the heating valve is tested.

If the devices cannot function, do NOT install the panel. Turn the power off and re-check the wire connections.

#### 4 Install panel

After installing the flush mounted module, you can start securing the panel.

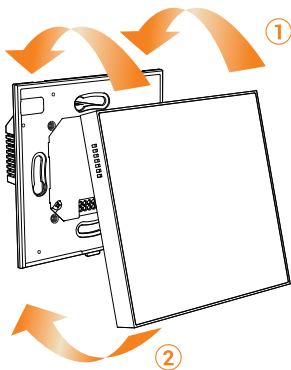

- Position the panel at a tilt as the picture shows.
- Press the panel into the flush mounted module until it clicks.

## If you need to remove the panel

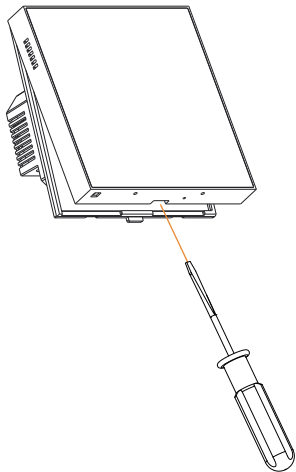

- Insert a flat-head screwdriver with about 6mm width into the slot at the bottom edge.
- Gently pry the panel up.

# Congratulations!

You are done with the HyPanel installation!  
Start your smart home journey with Akubela now!

## Get Help

For help or more assistance,  
contact us at: <https://ticket.akuvox.com/>

For videos, guides, and additional product formation,  
visit us at: <https://knowledge.akuvox.com>



YS51000040